



## ***ASL-250 and ASL-250HTP***

**Meridian™**

## **Operator's Manual**

**Technical Service email: [service@bruno.com](mailto:service@bruno.com)**

**[www.bruno.com](http://www.bruno.com)**

1780 EXECUTIVE DR., P.O. BOX 84, OCONOMOWOC, WI 53066 USA

TELEPHONE: (262) 567-4990

FAX: (262) 953-5501

1-800-882-8183

REV. 10-15-2007

# PRODUCT REGISTRATION FORM



## Product Registration Form Please print in CAPITAL letters.

Online registration available at <http://www.bruno.com/warranty.html>

Please be assured that Bruno **does not** share or sell the information you provide.

\* = required field

\*First Name \_\_\_\_\_ M.I. \_\_\_\_\_

\*Last Name \_\_\_\_\_

\*Street Address \_\_\_\_\_ Apt. \_\_\_\_\_

\*City \_\_\_\_\_ \*State/Province \_\_\_\_\_

\*Zip/Postal Code \_\_\_\_\_

Email Address \_\_\_\_\_

Telephone No. \_\_\_\_\_

Date of Purchase (mm/dd/yy) \_\_\_\_\_

Model No. \_\_\_\_\_

Serial No. \_\_\_\_\_

Please rate your satisfaction with your Bruno dealer:

excellent  good  average  poor

Please rate your satisfaction with your Bruno product:

excellent  good  average  poor

Bruno reserves the right to use information indicated on this form in its online, video, audio and printed materials. Names will be abbreviated to ensure the privacy and anonymity of the individual.

©2007,2005 Bruno Independent Living Aids, Inc.®

Rev. 04-01-07  
P/N PROD REG STD

Bruno is pleased to provide you with this mobility-enhancing product.

The Product Registration Form is shipped in a plastic bag with this manual. It is very important that you fill out and return this form at your earliest convenience so that we may complete the warranty registration process for your unit.

The **serial number** is found on labels affixed to the manual, as well as on the unit itself.

**Serial and model numbers must be provided** when filing a warranty claim, requesting service or ordering parts. We encourage you to keep this information readily available at all times.

Best wishes from the Bruno Team.

# TABLE OF CONTENTS

---

Safety . . . . . 4

Maximum Weight Rating . . . . . 5

Operation

    Steps for Both Scooters and Powerchairs. . . . . 6

    Scooters . . . . . 7-8

    Powerchairs . . . . . 9-10

    With Retractable Belts. . . . . 11-12

    Swing-Away. . . . . 13-14

**Emergency Operation. . . . . 15**

Maintenance. . . . . 16

Troubleshooting . . . . . 17

Warranty . . . . . 18-19

# SAFETY

---

- Load and unload from/to as level an area as possible.
- Maintain a safe distance from moving lift parts.

Keep hands and fingers away from moving lift parts and from docking linkage components (belt, T-bar, and claw) during up/down movement of the lift.

- Avoid unloading into vehicular traffic.
- Turn OFF the power source of the mobility device being lifted before attaching it to the lift.
- Do not overload or abuse the lift.
- Be sure the lift arm is latched securely before use.
- Keep feet from underneath the mobility device during lift operation.
- Do not remove any guards or covers.
- Do not allow parcels or other objects to rest on top of the pendant switches.

## MAXIMUM WEIGHT RATING

---

The maximum load rating decal for the specific vehicle is located on the lift base assembly. **This rating is appropriate for lifts installed according to Bruno instructions.**

<u>LIFT MODEL</u>	<u>MAXIMUM LOAD RATING</u>
ASL-250/ASL-250HTP	350 lb (159 kg)

## OPERATION – SCOOTERS AND POWERCHAIRS

---

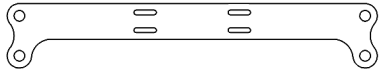

Retractable belt hooks attach to this docking plate.

### ***Using retractable belts to secure your power chair?***

- Have an authorized Bruno dealer remove the mobility device seat, mount the docking plate (see above) between the seat and the swivel plate of the mobility device and place the seat assembly back on the mobility device.

1. Open the keyswitch cover.
2. Insert the key and turn it to ON position.
3. Lift the control arm.
4. Press and hold the DOWN switch to lower the platform.
5. Release the switch when the platform reaches the ground.
6. Position the mobility device on the platform.

***See following pages for instructions specific to scooters and powerchairs.***

### *Scooters Using Hold-Tite mechanism:*

#### ***Loading***

- Lift the control arm.
- Press and hold the UP switch to raise the platform/mobility device, and to automatically lower the Hold-Tite mechanism.
- Release the switch when the platform reaches the uppermost position.
- Verify that the Hold-Tite foot contacts the scooter deck and secures the scooter. The scooter should not move. Adjust the Hold-Tite foot, if necessary.

#### ***Adjusting the Hold-Tite Foot***

- Loosen lock nut (a) and (b).
- Screw the foot up or down as necessary until the foot contacts the scooter deck and secures the scooter.
- Tighten both lock nuts (a) and (b).

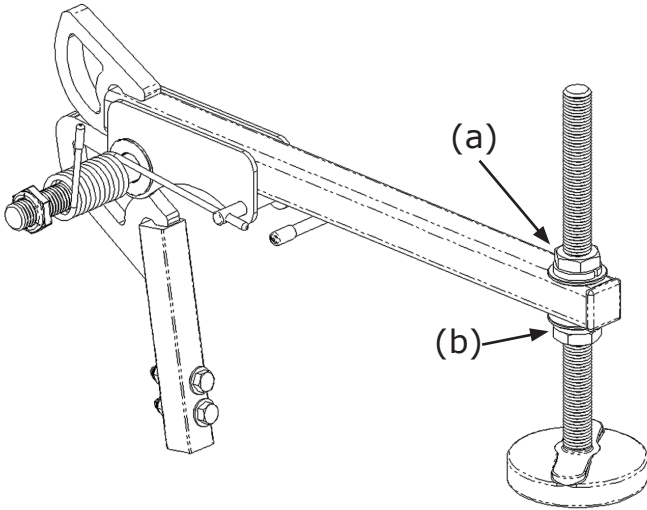

### *Scooters Using Hold-Tite mechanism:*

#### ***Unloading***

- Open the keyswitch cover.
- Insert the key and turn to the ON position.
- Lift the control arm.
- Press and hold the DOWN switch to lower the platform/mobility device, and to automatically lift the Hold-Tite mechanism.
- Release the switch when the platform reaches the ground.
- Drive it off of the platform.
- Lift the control arm.
- Press and hold the UP switch to raise the platform and fold it in its raised home position.
- Turn the key to the OFF position.
- Close the keyswitch cover.

## OPERATION – POWERCHAIRS

### ***Power Chairs Using Hold-Tite mechanism:***

#### ***Loading***

- Raise the powerchair armrests.
- Pull the T-handle out and turn it to the horizontal position. Release.
- Rotate the pivot arm over the powerchair seat (approx. 90 degrees).
- Turn the T-handle back to the vertical position. Release. It will click into the locked position.
- Lift the control arm.
- Press and hold the UP switch to raise the platform/mobility device.
- Release the switch when the pivot arm firmly compresses the powerchair seat-cushion. (It should be difficult to insert your fingers under the pivot arm at the edge of the cushion. See left.)



*NOTE: The lift will make a ratcheting sound when it has reached to upper stop position.*

### ***Power Chairs Using Hold-Tite mechanism:***

---

#### ***Unloading***

- Raise the powerchair armrests.
- Lift the control arm.
- Press and hold the DOWN switch to lower the platform/mobility device.
- Pull the T-handle out and turn it to the horizontal position. Release.
- Rotate the pivot arm off the powerchair seat (approx. 90 degrees).
- Turn the T-handle back to the vertical position. Release. It will click into the locked position.
- Drive the powerchair off the platform.
- Lift the control arm.
- Press and hold the UP switch to raise the platform and fold it in its home position.
- Turn the key to the OFF position.
- Close the keyswitch cover.

### ***Scooters, Power Chairs Using Retractable Belts:***

---

#### ***Loading***

- Open the keyswitch cover.
- Insert the key and turn it to ON position.
- Make sure an authorized Bruno dealer has installed the docking plate shown earlier in this manual.
- Lift the control arm.
- Press and hold the UP switch to raise the platform/mobility device.
- Release the switch when the platform reaches the uppermost position.
- While depressing the grey button, pull out and hook the (3) retractable belts to the plate secured to the bottom of the mobility device seat.
- Tighten belts by turning knob on belt housing in a clockwise direction.

## OPERATION – RETRACTABLE BELTS

---

### ***Scooters, Power Chairs Using Retractable Belts:***

---

#### ***Unloading***

- Lift the control arm.
- Press and hold the DOWN switch to lower the platform/mobility device.
- Release the switch when the platform reaches the ground.
- Loosen the belts by depressing the grey button.
- Unhook the (3) retractable belts from the plate secured to the bottom of the mobility device seat.
- Lift the control arm.
- Press and hold the UP switch to raise the platform and fold it in its home position.
- Turn the key to the OFF position.
- Close the keyswitch cover.

## OPERATION – SWING-AWAY

**! WARNING**

Risk of personal injury and/or property damage

Do not operate Swing-Away with a mobility device on board

**! WARNING**



**PINCH POINTS!**

- spacer plates
- lever cradle
- plate under lever
- spring

DEC-00286

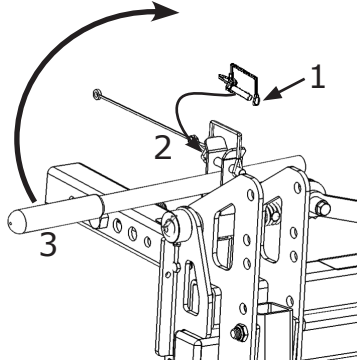
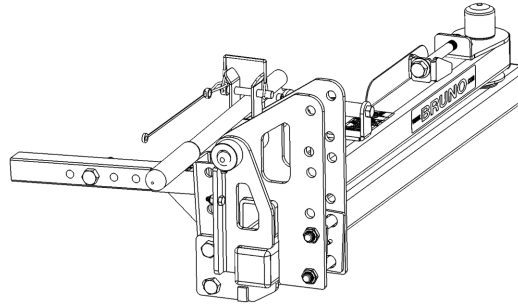

The Swing-Away allows access to the vehicle rear hatch when an ASL-250 Meridian™ or ASL-250HTP Meridian™ is installed on the vehicle.

### **WARNING!**

***To avoid the risk of personal injury and/or property damage, do not operate the Swing-Away with a mobility device on board.***

- Remove the pin lock (#1).
- Pull out the pin (#2).
- Lift the lever (#3).
- Swing the Meridian™ out and away from the vehicle.
- The vehicle hatch may now be opened.

## OPERATION – SWING-AWAY

### **WARNING!**

***To avoid the risk of personal injury and/or property damage, do not operate the Swing-Away with a mobility device on board.***

To return the Swing-Away to its closed and locked position:

- Close the vehicle hatch.
- Swing the Meridian™ in toward the vehicle.
- Push the lever (#3) down until it snaps between the holder.
- Insert the pin (#2).
- Slide the pin lock (#1) over the end of the pin.

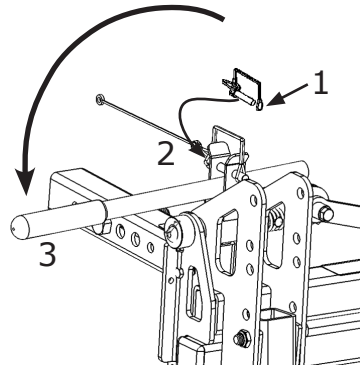
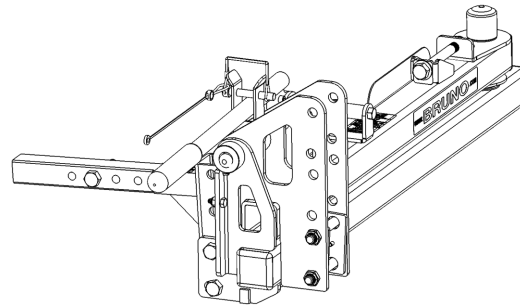

**! WARNING**

Risk of personal injury and/or property damage

Do not operate Swing-Away with a mobility device on board

**! WARNING**



**PINCH POINTS!**

- spacer plates
- lever cradle
- plate under lever
- spring

DEC-00286

## EMERGENCY OPERATION

---

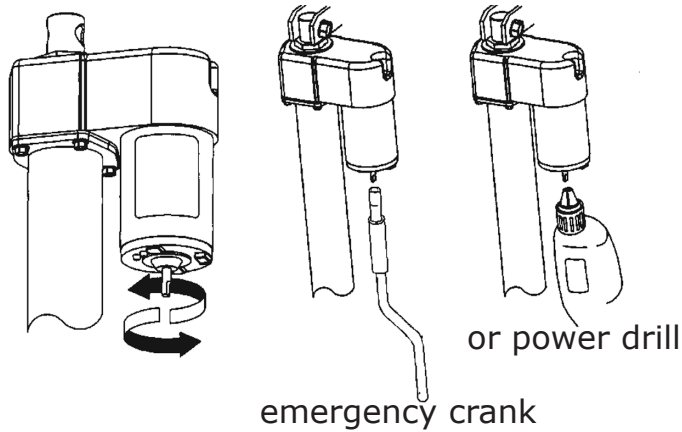

***Have an able-bodied person operate the emergency crank.***

Manual operation of the lift:

1. Turn the key switch to OFF.
2. Slide the deformed end of the crank onto the end of the motor shaft.
3. Lift and maintain the control arm in the UP position.
4. Rotate the crank:
  - *clockwise to raise* the platform;
  - **counterclockwise to lower** the platform.

NOTE: An electric drill with a 3/8" socket may be used to crank the shaft during emergency operation.

## MAINTENANCE

---

Bruno recommends having a qualified Bruno dealer clean, inspect and perform any necessary repairs and adjustments at least every twelve (12) months.

Maintenance is recommended more often if the lift is used (a) many times per day and/or (b) in harsh environments.

## TROUBLESHOOTING

<b><i>PROBLEM</i></b>	<b><i>PROBABLE CAUSE</i></b>	<b><i>REMEDY</i></b>
<b>Cannot raise lift control lever</b>	<ul style="list-style-type: none"><li>• safety latch engaged by slight downward drift of platform</li></ul>	<ul style="list-style-type: none"><li>• Momentarily depress the UP switch, then raise the control lever.</li></ul>
<b>Lift does not operate in either direction</b>	<ul style="list-style-type: none"><li>• keyswitch not turned to ON position</li></ul>	<ul style="list-style-type: none"><li>• Turn keyswitch to ON position.</li></ul>
<b>Lift operates slowly, lacks power or stalls</b>	<ul style="list-style-type: none"><li>• weak vehicle battery</li></ul>	<ul style="list-style-type: none"><li>• Have battery charged or run engine at fast idle for several minutes before attempting to operate lift.</li></ul>

**BRUNO GOLD**  
**THREE-YEAR LIMITED WARRANTY**  
**for**  
Bruno Vehicle Lift

Bruno Independent Living Aids, Inc.® (“Bruno”), warrants to the original purchaser of a Bruno Vehicle Lift that the Bruno Vehicle Lift is free from defects in material and workmanship for a period of three years from date of purchase.

The exclusive remedy for a defect in a Bruno Vehicle Lift shall be the repair or replacement, at the option of Bruno, of the defective part or component. After the first 30 days of this warranty, only parts and components are covered. This warranty does not cover labor and other services after the initial 30 days. If repair or replacement of a Bruno Vehicle Lift product is not commercially practical or cannot be timely made, Bruno may elect to refund the purchase price of the Bruno Vehicle Lift product instead of repairing or replacing the Bruno Vehicle Lift.

**IN NO EVENT SHALL BRUNO BE RESPONSIBLE FOR INDIRECT, INCIDENTAL OR CONSEQUENTIAL DAMAGES, WHETHER SUCH DAMAGES ARISE FROM CLAIMS BASED ON CONTRACT, WARRANTY, TORT (INCLUDING NEGLIGENCE), STRICT LIABILITY OR PRODUCT LIABILITY.**

Some states do not allow the exclusion or limitation of incidental or consequential damages, so the above limitation or exclusion may not apply to you.

**ALL IMPLIED WARRANTIES, INCLUDING ANY WARRANTY OF MERCHANTABILITY OR FITNESS FOR A PARTICULAR PURPOSE, ARE LIMITED IN THEIR DURATION TO THE LENGTH OF THE WARRANTY STATED ABOVE FOR THE AFFECTED COMPONENT.**

Some states do not allow limitations on how long an implied warranty lasts so the above limitation may not apply to you.

To obtain warranty service, you must follow these procedures:

1. Obtain return authorization by calling your local Bruno dealer ;
2. Return the Bruno Vehicle Lift, freight prepaid, to the address provided by your Bruno dealer or Bruno with proof of purchase indicating the date purchased.

Bruno will pay for shipping back to the purchaser within the continental United States and Canada if a defect in material or workmanship is discovered. Return freight and repair charges will be the responsibility of the purchaser if the problem is not covered by warranty.

This warranty does not cover damage or failure caused by misuse, abuse, accidents, physical damage, modifications not made by Bruno, damage in shipment, or repairs undertaken by anyone other than Bruno factory employees or authorized distributors. The "original purchaser" of a Bruno Vehicle Lift that is leased or rented shall be the person or entity acting as the lessee or rental provider.

This warranty gives you specific legal rights, and you may also have other rights which vary from state to state. Bruno specifically does not authorize any person to extend the time or scope of this warranty.

For further information regarding this limited warranty, please contact Bruno by calling 1-800-882-8183 or writing to Bruno at the following address:

**Bruno Independent Living Aids, Inc.®**  
**Attention: Service Department**  
**1780 Executive Drive, P.O. Box 84**  
**Oconomowoc, WI 53066 USA**

# *First in Performance. Built to Last!*



**Straight & Custom  
Curved-Rail Stairlifts**



**Vertical Platform Lift**



**Over 25 Different  
Vehicle Lift Solutions**



**Turning Automotive Seating**

**Bruno Independent Living Aids, Inc.<sup>®</sup>**  
1780 Executive Drive, P.O. Box 84, Oconomowoc, WI 53066  
262-567-4990 • FAX: 262-953-5501 • [www.bruno.com](http://www.bruno.com)

 **BRUNO<sup>™</sup>**  
for your independence

©2006 Bruno Independent Living Aids, Inc.<sup>®</sup> All illustrations and specifications in this brochure are based on the latest product information available at the time of publication. Bruno Independent Living Aids, Inc.<sup>®</sup> reserves the right to make changes at any time without notice. Manual Back Cover 8/06-2.

P/N 250-O